

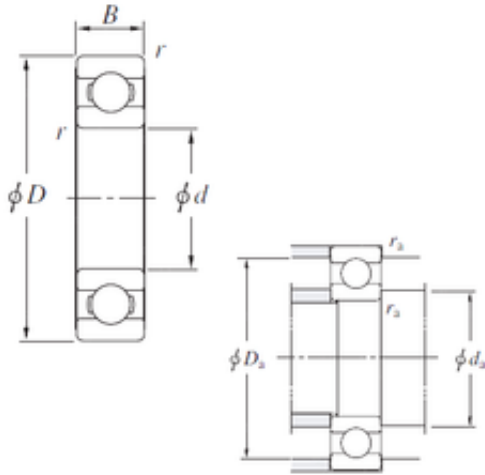

Machinery Parts Co., Ltd.



6836 Bearing 2D drawings and 3D CAD models

6836 KOYO Single-row deep groove ball bearings

Bearing No. 6836

Size	180x225x22 mm
Bore Diameter	180 mm
Outer Diameter	225 mm
Width	22 mm
d	180 mm
D	225 mm
B	22 mm
C	22 mm
r min.	1,1 mm
da min.	186,5 mm
Da max.	218,5 mm
ra max.	1 mm
Weight	2 Kg
Basic dynamic load rating (C)	60,7 kN
Basic static load rating (C0)	73,1 kN
(Grease) Lubrication Speed	2600 r/min
(Oil) Lubrication Speed	3000 r/min
Category	Single Row Ball Bearings
Inventory	0.0
Manufacturer Name	KOYO
Minimum Buy Quantity	N/A
Weight / Kilogram	1.825
Product Group	B00308
Enclosure	Open
Precision Class	ABEC 1 ISO P0



Machinery Parts Co., Ltd.

Maximum Capacity / Filling Slot	No
Rolling Element	Ball Bearing
Snap Ring	No
Internal Special Features	No
Cage Material	Steel
Internal Clearance	C0-Medium
Inch - Metric	Metric
Long Description	180MM Bore; 225MM Outside Diameter; 22MM Outer Race Diameter; Open; Ball Bearing; ABEC 1 ISO P0; No Filling Slot; No Snap Ring; No Internal Special Features
Category	Single Row Ball Bearing
UNSPSC	31171504
Harmonized Tariff Code	8482.10.50.68
Noun	Bearing
Keyword String	Ball
Manufacturer URL	http://www.koyousa.com
Manufacturer Item Number	6836
Weight / LBS	4.024
Outer Race Width	0.866 Inch 22 Millimeter
Bore	7.087 Inch 180 Millimeter
Outside Diameter	8.858 Inch 225 Millimeter
Bearing No.	6836
r(min)	1.1
Cr	75.8
C0r	73.1
Cu	2.65
f0	16.1
Grease lub.	2600
Oil lub.	3000



Machinery Parts Co., Ltd.

da(min)	186.5
Da(max)	218.5
ra(max)	1
(Refer.)Mass(kg)	2.00